

COUNTY OF LOS ANGELES

ROAD DEPARTMENT



POMONA QUAD

BENCH MARKS

1960

PREFACE

The Road Department level net is composed of some 1,000 miles of levels supporting more than 10,000 bench marks. In 1955, a major re-adjustment of the net was undertaken resulting in revised bench mark elevations of which the accompanying list is a part.

To facilitate the adjustment, indexing, and distribution of adjusted values of the net, the county territory was divided into 30 quads or areas. For identification purposes each quad was given a name, viz., "Rosemead", "La Mirada", "Santa Fe", etc. When bench marks and elevations in the Road Dept. net are used, the name of the quad in which the bench mark is located and the date of the adjustment of the elevation must be included in the bench mark description, e.g.,

SG 908 - L & T in E. cb. Miscatel Ave. on C/L prod.
Scott St. (Rosemead - 1955) Elev. 333.517

It is expected that this general adjustment will, for the most part, remain sound for the next 15 or 20 years. As new circuits are completed, however, re-adjustment of individual quads may become advisable. It is expected that these subsequent adjustments will be in the nature of a few hundredths of a foot. When a quad is re-adjusted, new elevation lists will be published and the date of the re-adjustment will replace the "1955" at the end of the bench mark description. Two bench marks in the same quad with different adjustment dates will not normally join each other. Since all adjustments taper out to nothing at the periphery of the quad, any bench mark in one quad will join any bench mark in another quad regardless of their respective adjustment dates.

The basic accuracy of the net is reflected by an indicated field probable error of ± 0.12 foot per mile of leveling as determined from 298 conditions of closure. However, many years experience in vertical control in the greater Los Angeles basin & Antelope Valley indicate that because of varying degrees of subsidence and heaving, the true datum is recovered only by obtaining substantial agreement of a number of bench marks.

The users of this net are invited to assist in its maintenance by notifying this Department of cases of obliteration, apparent mistakes in descriptions or elevations, and proven disturbance of bench marks.

Datum: U.S. Coast and Geodetic Survey Sea Level Datum of 1929, through the medium of the Los Angeles County Engineer Precise Level Net, 1952 Adjustment.

Abbreviations Used in Bench Mark Listings

ABUT--Abutment	L+BN--Lead and Bench Mark Nail
ANG PT--Angle Point	L+BR--Lead and Brad
BC--Beginning of Curve	L+N--Lead and Nail
BCR--Beginning of Curb Return	L+PK--Lead and PK Nail
BLDG--Building	L+SPK--Lead and Spike
BT SPK--Boat or Bolt Spike	L+T--Lead and Tack
CB RET--Curb Return	MCR--Middle of Curb Return
C/L INT--Center Line Intersection	MKD--Marked
C/L PROD--Center Line Produced	NR--Near
COE--Corps of Engineers	OPP--Opposite
CONC--Concrete	PI--Point of Intersection
CS MON--County Surveyor Monument	PK+W--PK Nail and Washer
CS BR CAP--County Surveyor Brass Cap Monument	P/L--Property Line
CT SPK--Cut Spike	P O S T--Point on Semi-tangent
CTR--Center	PP--Power Pole
DN--Down	PVMT--Pavement
DR--Driveway	R D--Road Department
EC--End of Curve	RDBM--Road Department Bench Mark
ENT--Entrance	RR--Railroad
FC--Flood Control (Dept. LA County)	SPK T+W--Spike, Tin and Washer
FTG--Footing	USC+GS--United States Coast and Geodetic Survey
HDWL--Headwall	USGS--United States Geological Survey
HSE--House	WK--Walk
IP--Iron Pipe	±--Plus or Minus
LACE--Los Angeles City Engineer	+--And

BASELINE RD.

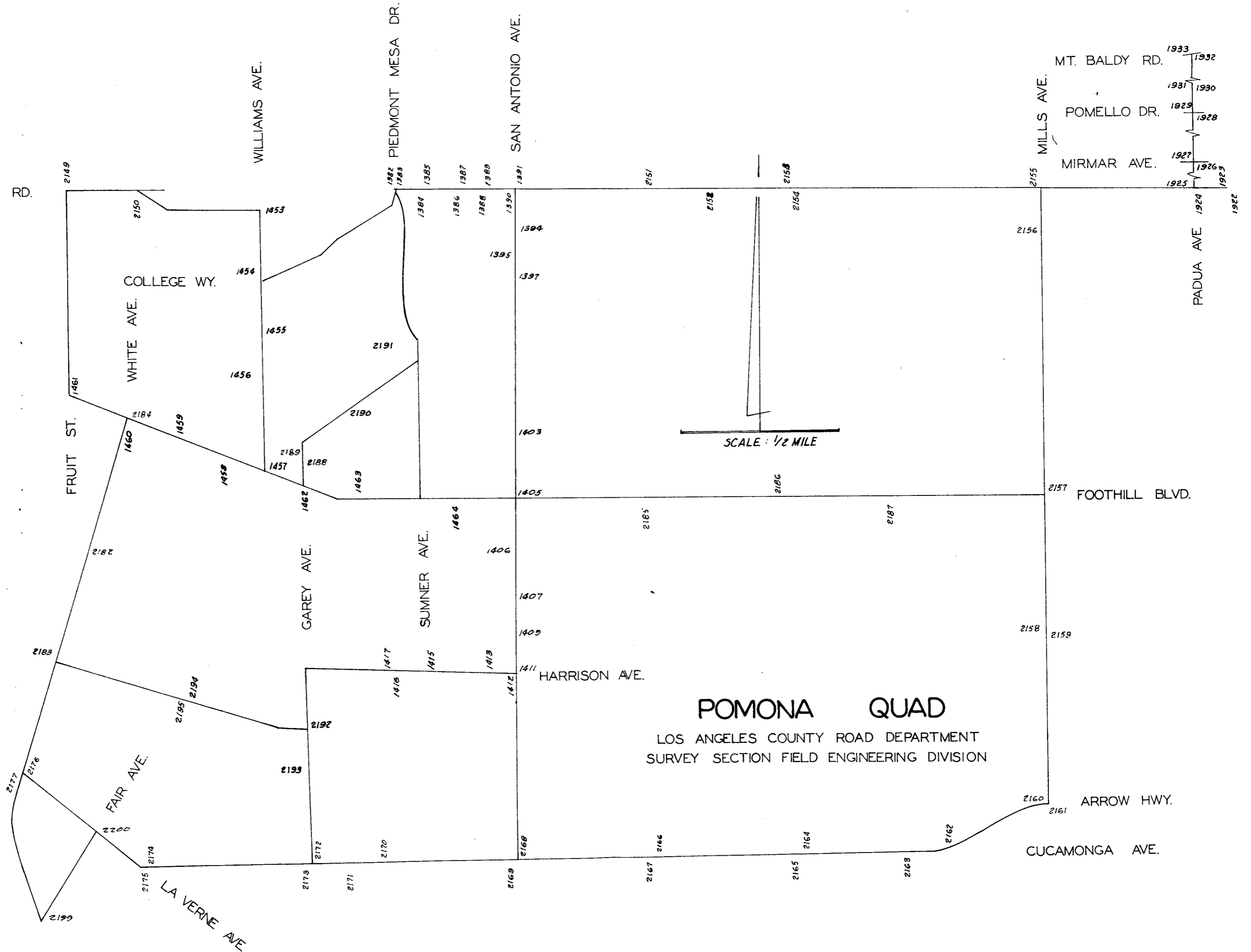

COLLEGE WY.

WHITE AVE.

FRUIT ST.

FAIR AVE.

LA VERNE AVE.

WILLIAMS AVE.

PIEDMONT MESA DR.

SAN ANTONIO AVE.

GAREY AVE.

SUMNER AVE.

HARRISON AVE.

MILLS AVE.

MT. BALDY RD.

POMELLO DR.

MIRMAR AVE.

FOOTHILL BLVD.

ARROW HWY.

CUCAMONGA AVE.

PADUA AVE.

SCALE: 1/2 MILE

POMONA QUAD

LOS ANGELES COUNTY ROAD DEPARTMENT
SURVEY SECTION FIELD ENGINEERING DIVISION

JUL 1964

LOS ANGELES COUNTY ROAD DEPARTMENT
 SURVEY SECTION FIELD ENGINEERING DIVISION

PAGE 1

QUAD-YEAR	ELEV	DESCRIPTION (INCLUDE QUAD AND YEAR IN DESCRIPTION)	BM NUMBER
POMONA (1960)	1345.642	USC+GS BR CAP 3FT N C/L PROD BASE LINE RD + 40FT NW C/L COLLEGE WAY MKD (USC+GS FRENCH)	SG 1382A
POMONA (1960)	1345.178	L+BN CONC WK TO HSE NO 353 BASE LINE RD 30FT N C/L + 55FT E C/L COLLEGE WAY	SG 1383A
POMONA (1960)	1236.844	CS MON IN WELL 2FT N C/L BASE LINE RD + 8FT W C/L LIVE OAK DR	SG 1384A
POMONA (1960)	1237.645	L+T E CB 12FT N BCR @ NE COR BASE LINE RD + LIVE OAK DR	SG 1385A
POMONA (1960)	1222.718	L+BN W CB OF DR TO HSE NO 509 BASE LINE RD 30FT S C/L	SG 1386A
POMONA (1960)	1308.852	L+BN W END OUT C/L DR TO HSE NO 521 BASE LINE RD 14FT N C/L + 200FT W WEBB CANYON RD	SG 1387A
POMONA (1960)	1295.737	L+BN SW COR OF BRIDGE NO 53309 12FT S C/L BASE LINE RD + 55FT W C/L SUMNER AVE	SG 1388A
POMONA (1960)	1294.461	L+SPK NE WALL TO BRIDGE NO 53309 15FT N C/L BASE LINE RD + 35FT W C/L SUMNER AVE	SG 1389A
POMONA (1960)	1298.795	CS MON IN WELL 1FT S + 1FT W C/L INT BASE LINE RD + SAN ANTONIO AVE	SG 1390A
POMONA (1960)	1298.028	L+BN TOP OF S CONC + ROCK PILLAR OF DR TO HSE NO 4353 SAN ANTONIO AVE	SG 1391A
POMONA (1960)	1270.832	L+T DOORWAY OUT ROCK HSE 200FT S RIDGEFIELD DR + 35FT W C/L SAN ANTONIO AVE	SG 1394A
POMONA (1960)	1269.415	L+BN IN E OUT C/L OF DR TO HSE NO 4140 SAN ANTONIO AVE + 15FT E C/L	SG 1395A
POMONA (1960)	1259.436	L+T SW COR DR TO HSE NO 4052 SAN ANTONIO AVE 55FT E C/L	SG 1396A
POMONA (1960)	1213.423	+BN SW COR CONC APRON GARAGE TO HSE NO 3728 SAN ANTONIO AVE 50FT E C/L	SG 1403
POMONA (1960)	1196.622	L+T 15FT W BCR @ SE COR SAN ANTONIO AVE + FOOTHILL BLVD	SG 1405
POMONA (1960)	1175.574	L+BN 1FT N BCR @ NE COR SAN ANTONIO AVE SERV RD + BUTTE ST + 200FT N GROVE ST	SG 1406
POMONA (1960)	1171.109	L+T S CB GROVE ST 27FT W C/L SAN ANTONIO AVE	SG 1407
POMONA (1960)	1152.870	L+BN N CB OUT DR TO HSE NO 2947 SAN ANTONIO AVE 32FT W C/L	SG 1409
POMONA (1960)	1134.244	BT SPK W CB SAN ANTONIO AVE 30FT S C/L HARRISON AVE	SG 1411
POMONA (1960)	1131.536	L+BN W CB SAN ANTONIO AVE 4FT N ALLEY BCR + 160 FT S C/L HARRISON AVE	SG 1412
POMONA (1960)	1130.540	L+BN N SIDE CONC OIL STORAGE TANK 750FT W SAN ANTONIO AVE + 40FT S C/L HARRISON AVE	SG 1413
POMONA (1960)	1115.556	L+BN S CB 2FT W BCR @ SW COR SUMNER AVE + HARRISON AVE	SG 1415
POMONA (1960)	1109.679	L+BN S CB HARRISON AVE 3FT E DR TO HSE NO 302	SG 1416A

QUAD-YEAR	ELEV	DESCRIPTION (INCLUDE QUAD AND YEAR IN DESCRIPTION)	BM NUMBER
PCMCNA (1960)	1109.259	L+BN S CB HARRISON AVE 50FT W DR TO HSE NO 302	SG 1417A
PCMCNA (1960)	1275.010	CS MON 5FT N C/L BASE LINE RD + 5FT W C/L WILLIAMS AVE	SG 1453A
PCMCNA (1960)	1258.103	L+BN IN S WINGWALL OF BRIDGE 15FT W C/L WILLIAMS AVE + 45FT S C/L POWDCIN ST MKD (SD 501)	SG 1454
POMONA (1960)	1224.010	L+BN IN N CB DARTMOUTH ST 70FT E WILLIAMS AVE + 7FT E OF CATCH BASIN MKD (SD 502)	SG 1455
POMONA (1960)	1185.402	L+BN W CB WILLIAMS AVE OPP HSE NO 3728	SG 1456A
POMONA (1960)	1162.772	L+N IN W END OF HDWL OF BRIDGE @ NE COR FOOTHILL BLVD + WILLIAMS AVE 50FT E C/L MKD (SD 503)	SG 1457A
BASELINE (1955)	1150.598	CS MON SE COR WHITE AVE + FOOTHILL BLVD 15FT E + 51FT S C/L INT	SG 1460A
POMONA (1960)	1166.558	L+T IN S CB 1FT W BCR @ SE COR GAREY AVE + FOOTHILL BLVD 2FT W OF CATCH BASIN	SG 1462A
POMONA (1960)	1173.079	L+BN S CB FOOTHILL BLVD 15FT W WK TO HSE NO 336 MKD (SD 507)	SG 1463A
POMONA (1960)	1180.449	L+BN N CB 5FT W BCR @ NW COR LYNOAK DR + FOOTHILL BLVD	SG 1464A
PCMCNA (1960)	1540.040	USC+GS MON IN CONC SLAB 4IN UP 375FT S C/L BASE LINE RD + 0.6MI E PADUA AVE 280FT SW OF WELL NO 2MKD (EAST BASE 2 1923)	SG 1922
PCMCNA (1960)	1549.770	USC+GS MON IN CONC SLAB 4IN UP 115FT S C/L BASE LINE RD + 0.6MI E PADUA AVE 85FT W OF WELL NO 3 MKD (EAST BASE 1923)	SG 1923
PCMCNA (1960)	1516.039	CS MON IN WELL 12IN DN @ C/L INT PADUA AVE + BASE LINE RD MKD (LA VERNE M 10 RE 2177)	SG 1924
PCMCNA (1960)	1517.938	L+T IN N RIM OF CONC RESERVOIR 40FT W + 28FT S C/L INT PADUA AVE + BASE LINE RD	SG 1925
PCMCNA (1960)	1600.241	CS MON IN WELL 8IN ND @ C/L INT PADUA AVE + MIRAMAR AVE MKD (RE 5869) USE W EDGE	SG 1926
PCMCNA (1960)	1604.413	L+T IN TOP OF W WINGWALL @ ENT TO DR 35FT E + 5FT S OF C/L INT PADUA AVE + MIRAMAR AVE MKD (BM)	SG 1927
PCMCNA (1960)	1685.870	RDBM TAG IN BRICK BASE OF FENCE 2FT W OF COR 30FT S + 32FT W C/L INT PADUA AVE + POMELLO DR	SG 1928
POMONA (1960)	1686.528	CS MON IN WELL 10IN DN @ C/L INT PADUA AVE + POMELLO DR USE NE EDGE	SG 1929
PCMCNA (1960)	1759.762	CS MON IN WELL 10IN DN @ C/L PADUA AVE 0.5MI N POMELLO DR NR DR TO HSE NO 4064 MKD (1/4 SEC T1N R8W S26-27) USE E EDGE	SG 1930
PCMCNA (1960)	1761.942	L+T IN CONC SLAB TO STEP @ HSE NO 4108 PADUA AVE 28FT E C/L + 0.5 MI N POMELLO DR MKD (BM)	SG 1931
PCMCNA (1960)	1807.687	RDBM TAG 18IN S OF N EDGE OF CONC DR 1FT E OF BLOCK PILLAR @ ENT TO L A CO FIRE STA NO 62 264FT N + 28FT W C/L INT PADUA AVE + MT BALDY RD	SG 1932

QUAD-YEAR	ELEV	DESCRIPTION (INCLUDE QUAD AND YEAR IN DESCRIPTION)	BM NUMBER
POMONA (1960)	1818.840	CHIS SQUARE IN TOP OF BOULDER ABOUT 2FT HIGH 24 FT S + 15FT W C/L INT PADUA AVE + CAMP BALDY RD + 270FT N L A CC FIRE STA NO 62	SG 1933
BASELINE (1955)	1171.272	CS MON IN WELL 2FT W C/L FRUIT ST + 100FT S C/L BASE LINE RD MKD (BM 13-11 1952 RE 63)	SG 2149
POMONA (1960)	1235.276	USC+GS TRI MON IN CONC 1635FT E FRUIT ST 15FT N C/L BASE LINE RD MKD (USC+GS BM)	SG 2150
POMONA (1960)	1346.865	CS MON IN WELL 2FT N C/L BASE LINE RD + 2FT E C/L MOUNTAIN AVE MKD (LA VERNE 110 RE 2177)	SG 2151
POMONA (1960)	1374.625	USC+GS MON ON E SIDE OF RESERVOIR 160FT S C/L BASE LINE RD + 57FT W C/L OXFORD AVE MKD (USC+GS BM F-36)	SG 2152
POMONA (1960)	1394.652	USC+GS MON IN CONC POST @ SW COR 28FT S BASE LINE RD + 35FT W INDIAN HILL BLVD MKD (USC+GS BM D-36)	SG 2152
POMONA (1960)	1394.777	CS MON IN WELL 2FT N BASE LINE RD + 4FT E INDIAN HILL BLVD MKD (TRA STA LA VERNE J-10 RE 2177)	SG 2154
POMONA (1960)	1467.416	CS MON IN WELL 2FT S C/L BASE LINE RD + 2FT W C/L MILLS AVE MKD (TRA STA LA VERNE L-10)	SG 2155
POMONA (1960)	1390.226	CS MON IN WELL 2FT S BASE LINE RD + 1FT W C/L MILLS AVE MKD (TRA STA LA VERNE L-1 RE 2177)	SG 2156
POMONA (1960)	1306.628	CS MON IN WELL 2FT N C/L FOOTHILL BLVD + 20FT E C/L MILLS AVE MKD (CSBM 11-70 RE 63)	SG 2157
POMONA (1960)	1224.418	L+T N CB 6TH ST 10FT W BCR @ NW COR MILLS AV 18FT N + 49FT W C/L INT	SG 2158
POMONA (1960)	1223.536	CS MON IN WELL 7FT W C/L MILLS AVE + 4FT N C/L 6TH ST MKD (TRA STA CLAREMONT L-1 1939 RE 2177)	SG 2159
POMONA (1960)	1152.287	CS MON IN WELL @ C/L INT ARROW HWY + MILLS AVE MKD (RE 2177)	SG 2160
POMONA (1960)	1153.654	L+BN S CB ARROW HWY 1FT E BCR @ SE COR MILLS AVE 30FT S + 77FT E C/L INT	SG 2161
POMONA (1960)	1118.152	L+BN W CB 21FT S BCR @ SW COR 18FT W C/L VILLANOVA DR 85FT S C/L ARROW HWY + 66FT S C/L CUCAMONGA AVE PROD FROM E	SG 2162
POMONA (1960)	1108.475	L+PK W CB COLLEGE AVE 52FT N BCR @ NW COR ARROW HWY 26FT W + 52FT N C/L INT	SG 2163
POMONA (1960)	1109.993	RDBM TAG S CB 10FT E END OF CB 50FT S C/L ARROW HWY + 210FT E C/L INDIAN HILL BLVD	SG 2164
POMONA (1960)	1111.728	SPK E CB INDIAN HILL BLVD 12FT N BCR @ NE COR ARROW HWY 18FT E + 55FT N C/L INT	SG 2165
POMONA (1960)	1091.064	CS MON IN WELL @ C/L INT MOUNTAIN AVE + CUCAMONGA AVE (ARROW HWY TO E) MKD (TRA STA CLAREMONT L-2 1939 RE 2177)	SG 2166
POMONA (1960)	1091.468	L+PK W CB MOUNTAIN AVE 1FT S BCR @ SW COR CUCAMONGA AVE (ARROW HWY) 20FT W + 71FT S C/L INT	SG 2167
POMONA (1960)	1069.089	RDBM TAG IN S CB CUCAMONGA AVE 1FT W BCR @ SE COR SAN ANTONIC AVE 42FT S + 59FT E C/L INT	SG 2168

QUAD-YEAR	ELEV	DESCRIPTION (INCLUDE QUAD AND YEAR IN DESCRIPTION)	BM NUMBER
POMONA (1960)	1070.547	RDBM TAG IN N CB SAN ANTONIO AVE 3FT W BCR @ NW COR CUCAMONGA AVE 39FT N + 68FT W C/L INT	SG 2169
POMONA (1960)	1050.692	L+BN E CB KIMBALL AVE 11FT N BCR @ NE COR CUCAMONGA AVE 18FT E + 62FT N C/L INT	SG 2170
POMONA (1960)	1044.731	L+BRAD E CB MAPLE AVE 2FT N BCR @ SE COR CUCAMONGA AVE 18FT E + 75FT S C/L INT	SG 2171
POMONA (1960)	1039.895	RDBM TAG S CB CUCAMONGA AVE 1FT E BCR @ SE COR GAREY AVE 40FT S + 60FT E C/L INT	SG 2172
POMONA (1960)	1040.993	RDBM TAG IN N CB CUCAMONGA AVE 2FT W BCR @ NW COR GAREY AVE 40FT N + 64FT W C/L INT	SG 2173
POMONA (1960)	1028.634	L+T NR NW COR OF CONC DRWY TO HSE NO 475 31FT NE C/L LA VERNE RD + 110FT S C/L CUCAMONGA AVE	SG 2174
POMONA (1960)	1029.557	L+T CONC W SIDE OF HSE NO 460 35FT SW C/L LA VERNE RD + 242 S C/L INT CUCAMONGA AVE	SG 2175
BASELINE (1955)	1037.725	CS MON IN WELL 1FT E OF E CB WHITE AVE 104FT N C/L ARROW HWY (LA VERNE RD) + 27FT E C/L WHITE AVE MKD (BM 13-7 RE 63 1952)	SG 2176
BASELINE (1955)	1037.450	RDBM TAG IN W CB WHITE AVE 1FT S BCR @ SW COR ARROW HWY 34FT W + 68FT S C/L INT	SG 2177
BASELINE (1955)	1082.747	CS MON IN WELL 2FT N OF N CB 7TH ST 17FT W BCR @ SW COR WHITE AVE 18FT N + 43FT W C/L INT	SG 2182
BASELINE (1955)	1064.973	L+BN W CB WHITE AVE 10FT S BCR @ SW COR BONITA AVE 25FT W + 71FT S C/L INT	SG 2183
BASELINE (1955)	1152.832	COE MON 3IN UP @ SW COR FOOTHILL BLVD + LINCOLN AVE (WHITE AVE) 41FT S + 21FT W C/L INT	SG 2184
POMONA (1960)	1231.012	BT SPK E CB @ NE COR MOUNTAIN AVE + FOOTHILL BLVD MKD (SD 515)	SG 2185
POMONA (1960)	1253.769	BT SPK @ SW COR INDIAN HILL BLVD + FOOTHILL BLVD MKD (BM KK 49)	SG 2186
POMONA (1960)	1282.105	L+PK @ NW COR FOOTHILL BLVD + COLLEGE AVE MKD (33)	SG 2187
POMONA (1960)	1183.403	COE MON FLUSH 1FT BACK OF W CB GAREY AVE 25FT S OF END + 0.2MI N FOOTHILL BLVD MKD (TSF 127 1960)	SG 2188
POMONA (1960)	1185.444	CS TAG NW COR CONC DR TO HSE NO 3726 GAREY AVE 36FT E C/L + 0.2MI N FOOTHILL BLVD	SG 2189
POMONA (1960)	1222.372	FC MON FLUSH 78FT N C/L PROD TEASDALE AVE + 250FT W OF E TEASDALE AVE MKD (BM 105-7)	SG 2190
POMONA (1960)	1250.606	COE MON FLUSH 0.2MI N TEASDALE DR 25FT E C/L SUMNER AVE MKD (TSJ 128 1960)	SG 2191
POMONA (1960)	1083.371	CAL STATE HWY MON IN WELL @ C/L INT GAREY AVE + BONITA AVE	SG 2192
POMONA (1960)	1067.890	L+PK W CB GAREY AVE 40FT W C/L 45FT N C/L PERR R/W + 100FT S C/L AT+SF R/W	SG 2193
POMONA (1960)	1078.631	L+T 1FT N OF N CB @ CTR OF CULV BRIDGE 30FT N C/L BONITA AVE + 59FT E C/L FULTON RD PROD	SG 2194
POMONA (1960)	1078.775	L+T E END OF CULV BRIDGE 36FT S C/L BONITA AVE + 47FT E C/L FULTON RD	SG 2195

JUL 1964

LOS ANGELES COUNTY ROAD DEPARTMENT
SURVEY SECTION FIELD ENGINEERING DIVISION

PAGE 5

QUAD-YEAR	ELEV	DESCRIPTION (INCLUDE QUAD AND YEAR IN DESCRIPTION)	BM NUMBER
BASELINE (1955)	996.286	CS MON IN WELL IN L A CO FAIR GROUNDS @ CHAIN LINK FENCE ON E PROP LINE OF FAIR GROUNDS 18FT NW C/L PROD FAIR AVE 118FT W C/L WHITE AVE NR PP NO 1199570E MKD (LACFG NO 53)	SG 2199
POMONA (1960)	1019.608	L+BN N CB 2FT E CB END @ W PL HSE NO 2240 0.1MI W LAVERNE RD 15FT N C/L FAIR AVE	SG 2200